



The Intersection of Science + Design

Our History

- Today, J.W. Speaker Corporation is still family owned and ran business
- Lead by Tim and Jamie Speaker with their management team
- Development of world leading LED forward lighting for key OEM worldwide
- Growing into the aftermarket with the latest LED performance technology
- Expanding into different markets around the global as a key brand
- Work closely with our OEM and aftermarket distributor to develop the world first LED headlamps, work lamps and safety products
- To meet all our customers need and wants with latest technology in LED lighting

Our History

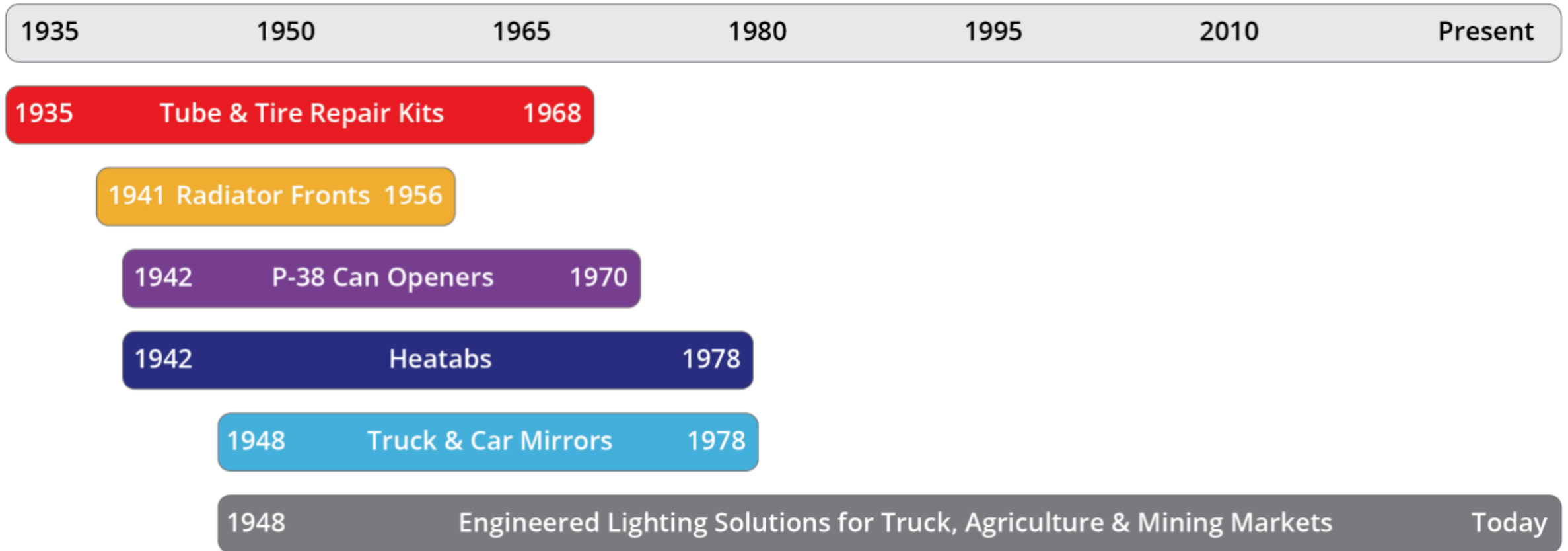



Design Manufacturing Innovative Products for Over 80 years



ATLAS COPCO BLASTHOLE DRILLS DM30

Safety Through Innovative Lighting Product

By **J.W. Speaker**

The Intersection of Science + Design

ATLAS
COPCO
BLASTHOLE
DRILLS
DM30



Dimensions tower up

Length	28 ft 7 in	8.7 m
Height	45 ft 2 in	13.77 m
Width	16 ft 11 in	5.16 m

Dimensions tower down

Length	44 ft 11 in	13.7 m
Height	16 ft 8 in	5.09 m

Front View:

① Model 523 Wide Flood

① Option add Model 523 wide Flood to add more light in front



Side View:

- 1 Model 832 Trap on Roof point up the mast
- 1 Option add Model 832 Flood pointing out





Side View:

① Model 523 Wide Flood
Top of cab 1 facing rear more to
the end of cab and 1 to the side

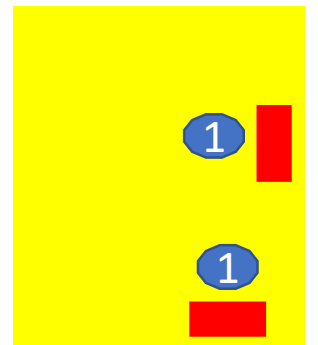

Side View:

- ① Model 523 Wide Flood
- ① Model 832 Flood pointed more over drilling platform
- ① Option add Model 832 Flood pointing out



Rear View:

1 Model 832 Trap



V.R. Mapping For ATLAS COPCO DM30

ATLAS COPCO DM 30 VR Mapping



- Model 523 and 832 for illumination area
- Model 523 IP67 10-30VDC, weight 3.05kg
- Raw Lumen 8,100 and Effective 3,900 Lumen
- Colour Temperature 5000K (Kelvin), Daylight at High Noon 5500k
- Model 832 IP69K 10-32VDC, weight 0.83kg
- Raw Lumen 3,900 and Effective 2,400 Lumen
- Colour Temperature 5700K (Kelvin), Daylight at High Noon 5500k

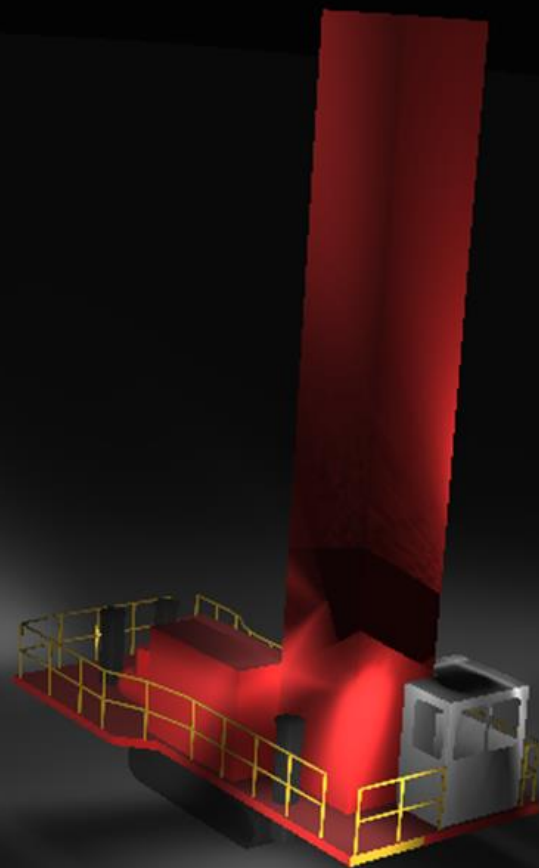

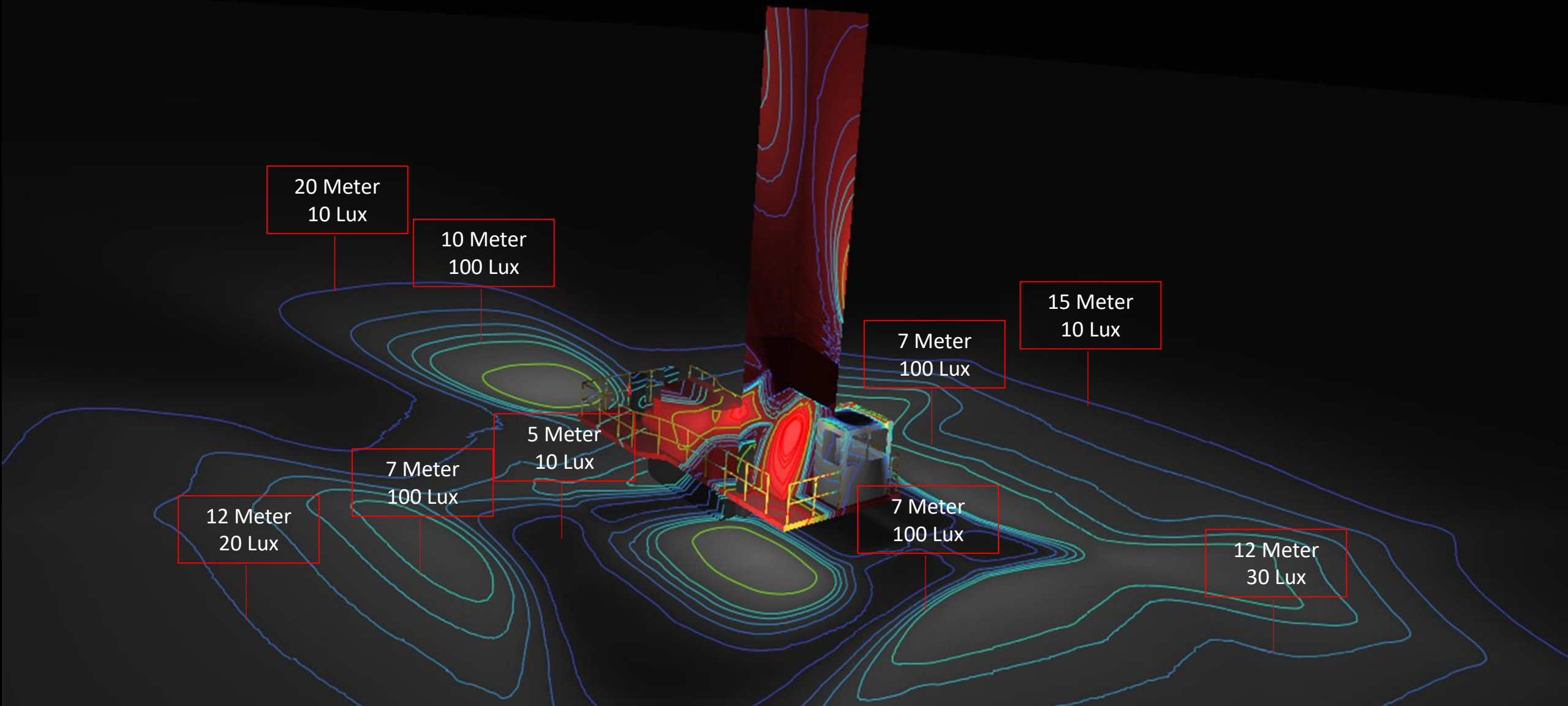

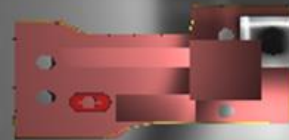

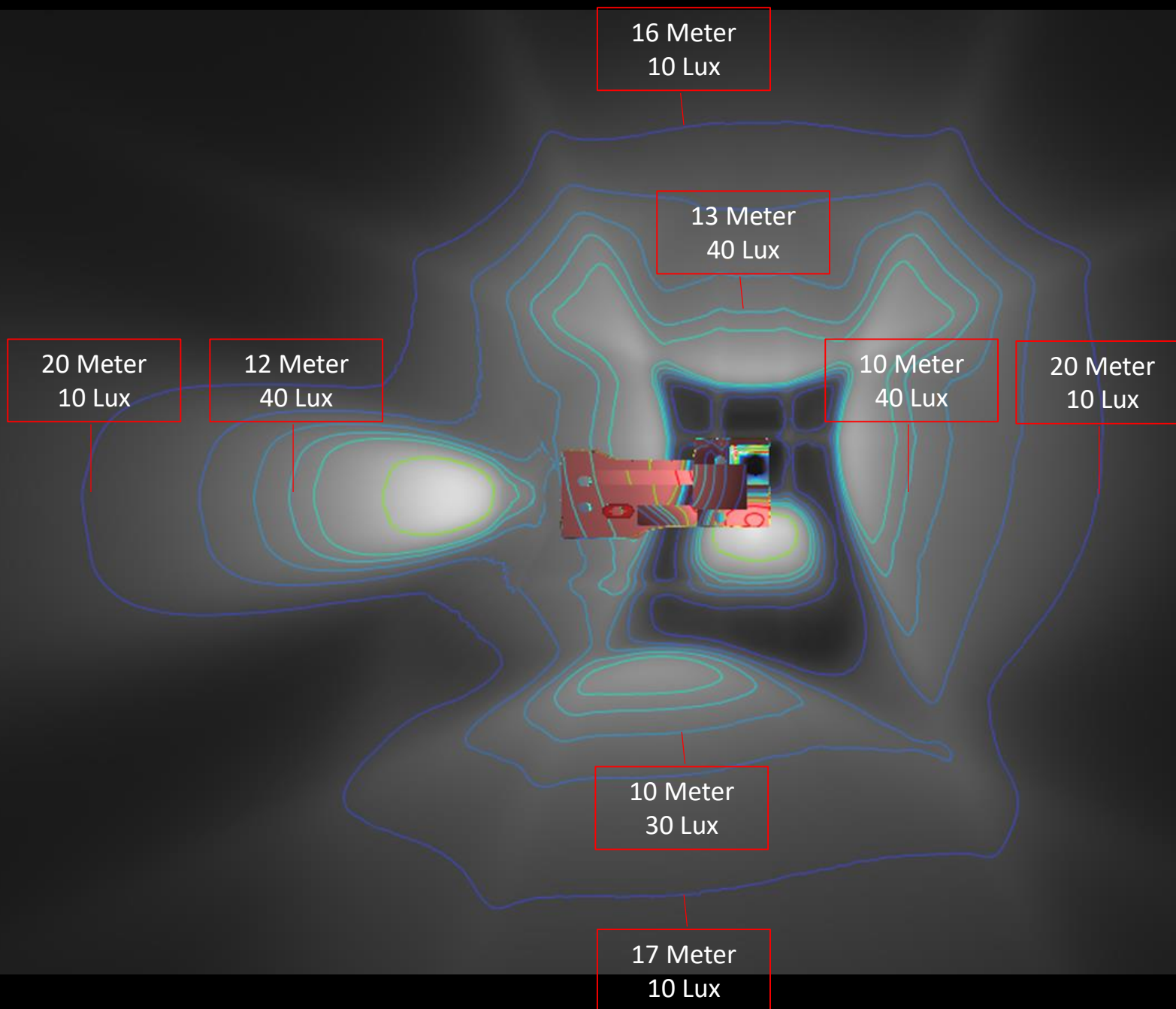

DM 30 Product



PRODUCT INFORMATION

Description	12-24V LED Auxiliary Light
Height	154.94 mm / 6.1 in
Width	115.06 mm / 4.53 in
Depth	68.58 mm / 2.7 in
Shape	Square
Outer Lens Material	Polycarbonate
Outer Lens Color	Clear
Housing Material	Die-Cast Aluminum
Housing Color	Black
Mounting Hardware Description	(x1) 5/16"-18 x 0.58" Mounting Bolt
Mounting Type	Universal Pedestal Mount
Minimum Operating Temperature	-40 °C / -40 °F
Maximum Operating Temperature	65 °C / 149 °F
Connector or Wiring	Integrated 2-Pin Deutsch Weather-Proof Socket (DT04-2P)
Mating Connector	2-Pin Deutsch Weather-Proof Plug (DT06-2S)
Product Weight	1.82 lbs / 0.83 kgs
Shipping Weight	1.82 lbs / 0.83 kgs

ELECTRICAL SPECIFICATIONS

Input Voltage	12-24V DC
Operating Voltage	10-32V DC
Red Wire	Positive
Black Wire	Negative
Current Draw	3.5A @ 12V DC 1.75A @ 24V DC

REGULATORY STANDARDS COMPLIANCE



Buy America Standards
IEC IP69K



Eco Friendly
UL Recognized

PHOTOMETRIC SPECIFICATIONS



Raw Lumen Output	3,900
Effective Lumen Output	2,400
Nominal LED Color Temperature	5700 K



Model 832
1 Flood 2 Trap
Option Add 2 more Flood

DM 30 Product



PRODUCT INFORMATION		ELECTRICAL SPECIFICATIONS		PHOTOMETRIC SPECIFICATIONS	
Description	12-24V LED Work Light with Wide Flood Beam Pattern	Input Voltage	12-24V DC	Raw Lumen Output	8,100
Height	177.55 mm / 6.99 in	Current Draw	6.70A @ 12V DC 3.70A @ 24V DC	Effective Lumen Output	3,900
Width	253.75 mm / 9.99 in	REGULATORY STANDARDS COMPLIANCE		Nominal LED Color Temperature	5000 K
Depth	88.90 mm / 3.5 in			Beam Pattern(s)	Forward Lighting - Flood (Super Wide)
Shape	Rectangular				
Outer Lens Material	Glass				
Outer Lens Color	Clear				
Housing Material	Die-Cast Aluminum				
Housing Color	Black				
Mounting Hardware Description	(x1) 1/2"-Mounting Bolt	 		Model 523 4 Wide Flood Option add 1 more Wire Flood	
Mounting Type	Universal Pedestal Mount				
Maximum Operating Temperature	65 °C / 149 °F	Buy America Standards	Eco Friendly		
Connector or Wiring	Integrated 2-Pin Deutsch Weather-Proof Socket (DT04-2P)	IEC IP67			
Product Weight	6.72 lbs / 3.05 kgs				
Shipping Weight	8.40 lbs / 3.81 kgs				

Summary

- Illumination colour temperature of 5000K and 5700K, Daylight at High Noon is 5500k
- CRI of 90+ reproduce the colours of various objects as "realistically" or "naturally"
- Design for industrial application
- Model 523 and 832 LED Work Lamp 5 year warranty
- Design and manufacture in USA

Commitment

- J.W. Speaker are fully commit to the Safety in all mining equipment from the correct illumination and Red Zone area
- To work direct with the OEM and Industrial site to design and develop product to suit the industrial market
- All product are available worldwide through key distributions who comprehend the Industrial Market to meet all demand

Thank you

N120 W19434 Freistadt Road
Germantown, WI 53022 USA

www.jwspeaker.com